

Retail

*430 E Patrick St
Frederick, MD*

For Lease



\$12.00/SF
+NNN

AVAILABLE SPACE

~~Unit A~~
2,400 SF

**Unit B
1,230 SF**

- ★ Plenty of Parking
- ★ Road Signage
- ★ Great Visibility
- ★ Near Fairgrounds



Dave Chapin 240-436-6200 ★ Doug Chapin 301-788-4039

www.realestateinfrederick.com ★ www.chapincommercial.com

329A E. 2nd St. • Frederick, MD 21701

Main Office 240-436-6200



Local Knowledge. Quality Service.

ALL INFORMATION DEEMED RELIABLE BUT NOT GUARANTEED

Retail

*430 E Patrick St
Frederick, MD*

Unit A



2,400 SF Retail

- ★ Convenience Store
- ★ Restaurant/Deli
- ★ Built-In Counter
- ★ Beverage & Food Counters
- ★ Beverage Cooler
- ★ 32' x 40' x 12' Walk-In Refrigerator
- ★ 12' x 12' x 12' Walk-In Freezer
- ★ 12' x 12' x 12' Walk-In Freezer
- ★ 12' x 12' x 12' Walk-In Freezer
- ★ 12' x 12' x 12' Walk-In Freezer



LEASED



ALL INFORMATION DEEMED RELIABLE BUT NOT GUARANTEED

Retail

*430 E Patrick St
Frederick, MD*

Unit A

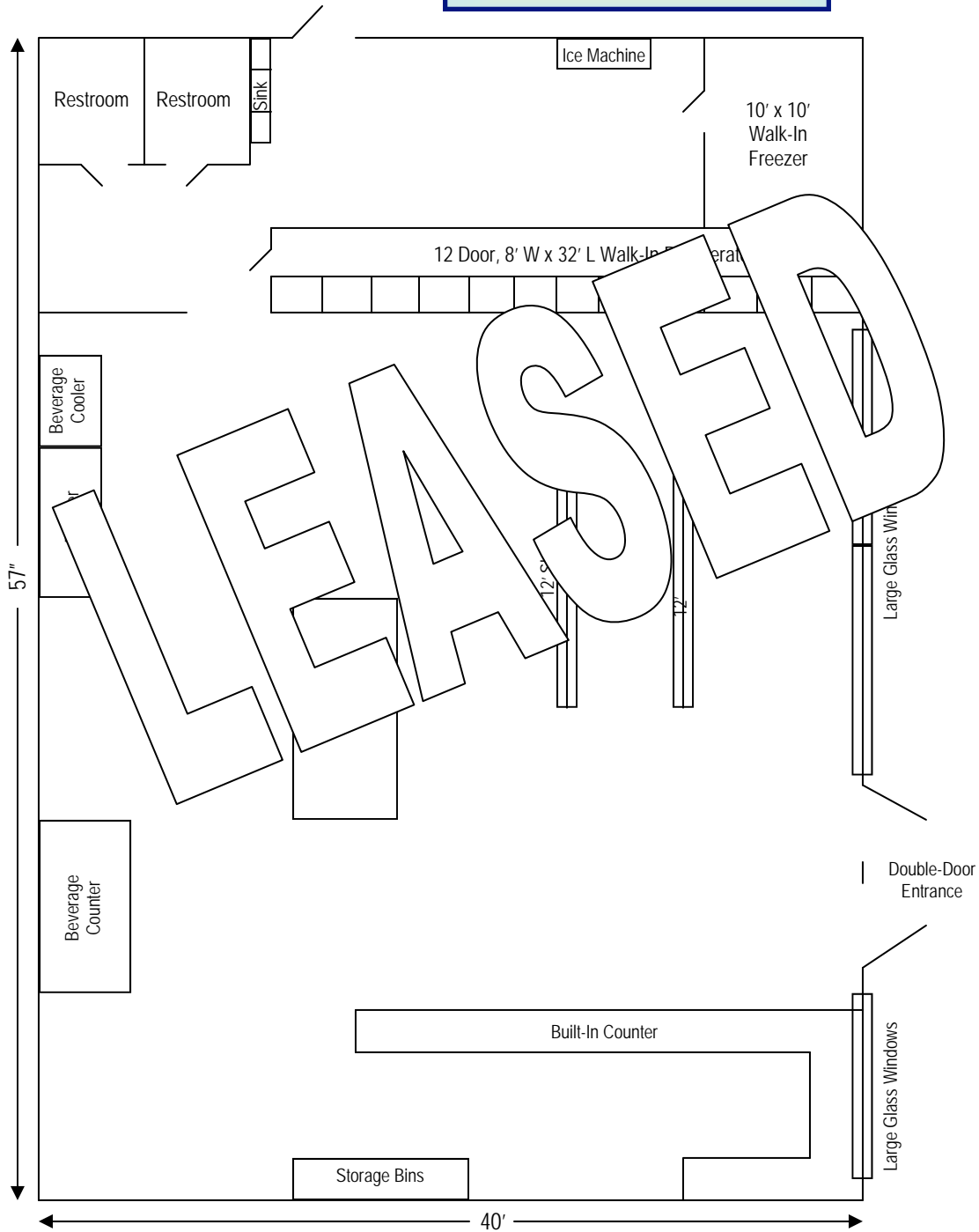

ALL INFORMATION DEEMED RELIABLE BUT NOT GUARANTEED

Retail

*430 E Patrick St
Frederick, MD*

Unit B



1,230 SF Retail

- ★ 29' x 29' Front Retail Space
- ★ 10'x 10' Office/Storage Room
- ★ Built-In Water Fountain
- ★ Restroom



Retail

*430 E Patrick St
Frederick, MD*

Unit B

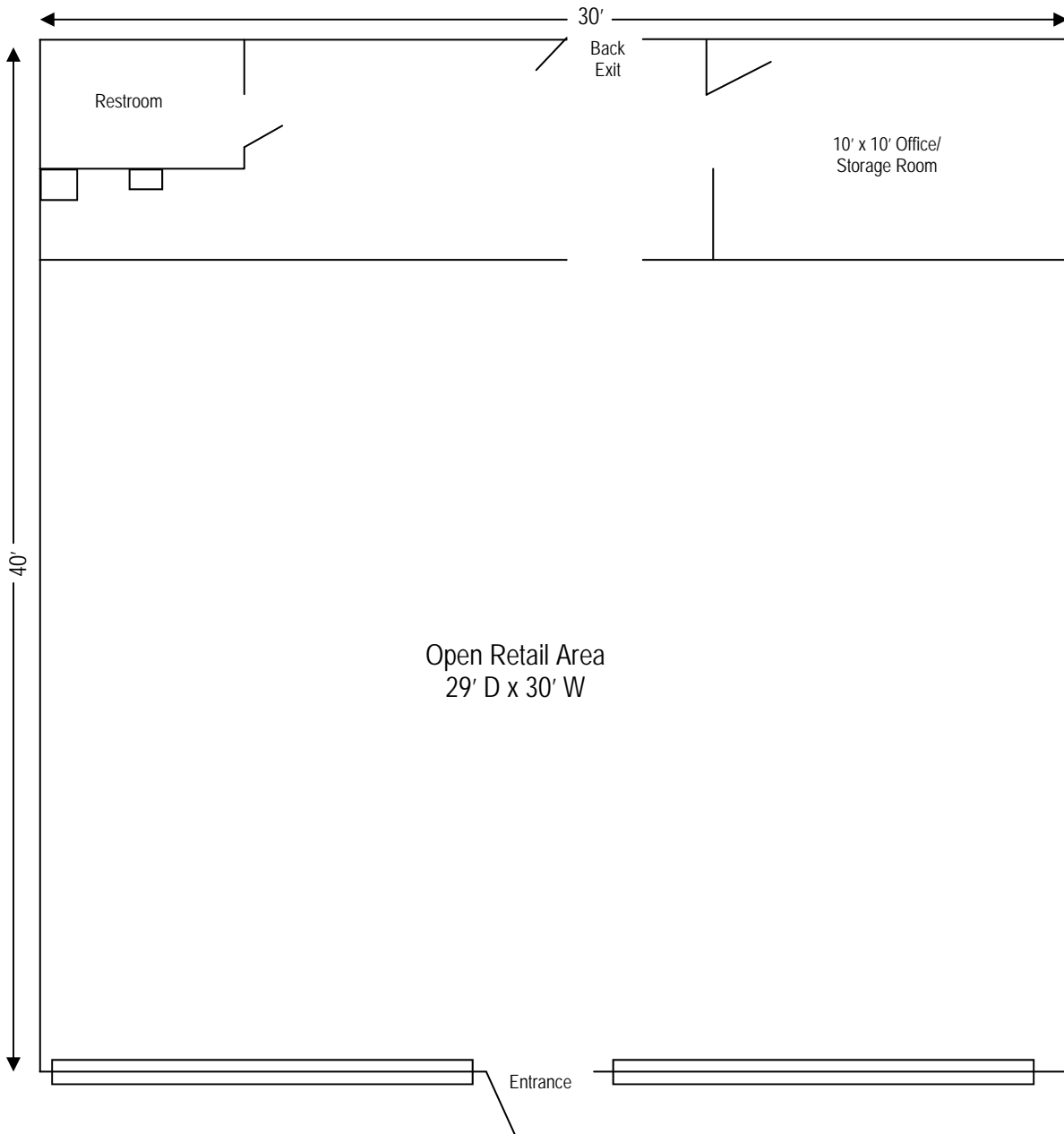

Drawing Not to Scale

ALL INFORMATION DEEMED RELIABLE BUT NOT GUARANTEED

430 E Patrick St Frederick, MD

Street & Aerial Maps

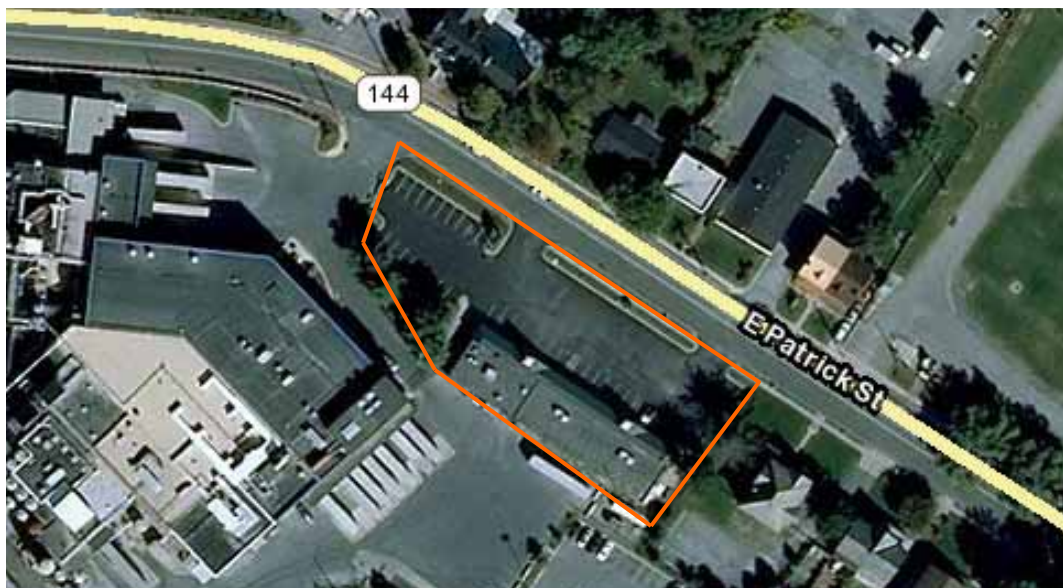
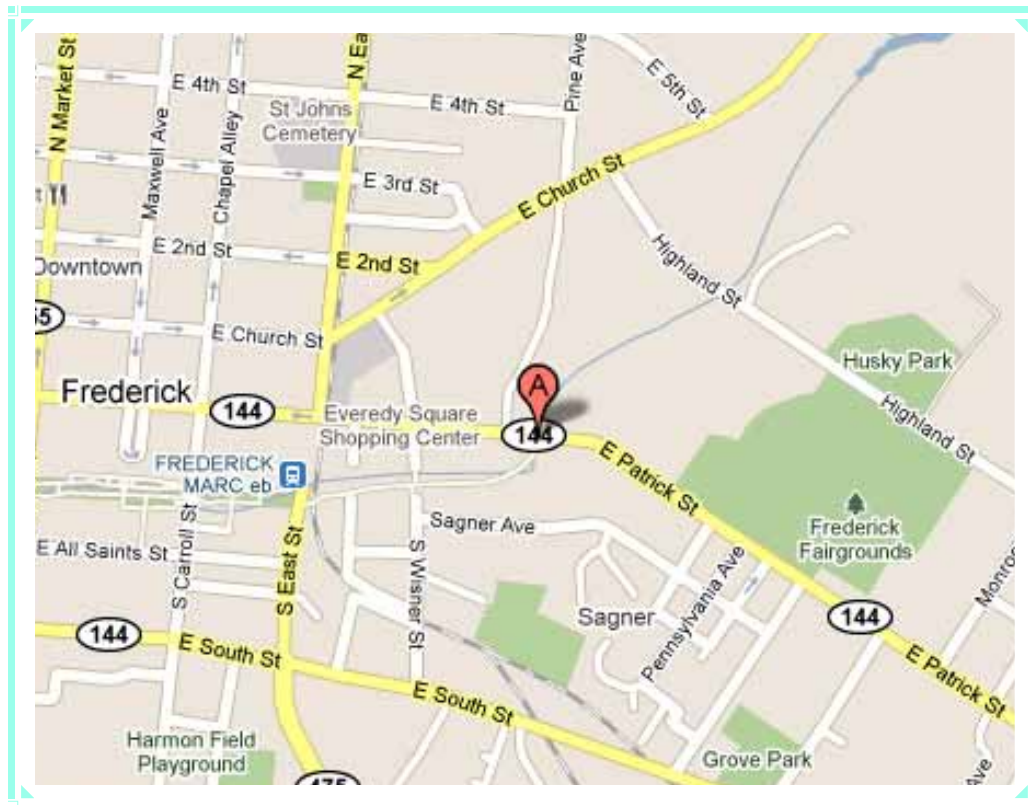

ALL INFORMATION DEEMED RELIABLE BUT NOT GUARANTEED